

Korlok Installation Instructions with a 5G locking profile

General Information

Korlok is a fully waterproof* floating floor with excellent acoustic and thermal properties made lightweight and rigid to assist installation over uneven subfloor surfaces. It is essential that these installation instructions are followed to ensure a quality fit.

Korlok is suitable for commercial and residential use, but it is not suitable for installation outdoors nor in rooms that will be continually wet. (It is suitable for use in traditional residential bathrooms, kitchens, laundry /utility rooms).

Install permanent fixtures prior to installation of Korlok, leaving a space for expansion and contraction, see below.

Fill expansion spaces around potentially wet areas with an acrylic caulk.

A separate underlayment is not required.

Acclimation of Material

For commercial installations make sure flooring materials are removed from packaging at least 48 hours prior to installation, (planks may be stacked, but must be rested flat) and allowed to condition in the room where the installation is to take place. Room temperature must be kept between 64-81°F (18-27°C).

For residential installations acclimatisation is not essential if the product temperature is already in the range 64-81°F (18-27°C).

To achieve a more natural look to your floor, we recommend that the product in this box is shuffled before installation.

Subfloors

Before Korlok may be installed, all subfloors should be solid and sound, smooth and level, clean and swept free of all debris. Measured moisture must be less than 95% RH, (or no more than 5 lbs. moisture/1000 ft²/24 hours :- calcium chloride test). Any unevenness in the subfloor should be limited to a maximum of 3/16" (5 mm) below the level in any in 10' (3 m) diameter. Any isolated highpoints/ridges should first be removed in order to avoid damage to the product.

Concrete/screeds

For an RH between 75%-95% RH where the subfloor is uneven an appropriate smoothing compound should be selected.

Quarry tiles/mosaics/terrazzo/ceramics

Level any grout lines with a width and/or depth of more than 0.2" (5 mm)..

- Timber floors: These should be solid with little flexibility. All loose boards must be firmly fastened and gaps filled. Wood block floors laid direct to earth/bitumen/pitch must be removed prior to installation.
- Linoleum/Thermoplastic/Vinyl/Cork Floors: Make sure these floors are solid; fix any loose tiles.

Misc.

Any existing floors installed with cutback adhesive must first be suitably covered/encapsulated.

Metal and painted floors

Remove any loose paint or other finishes.

Textile floor coverings

(including carpet) must be removed.

Underfloor heating

It is possible to install **Korlok** over floors incorporating underfloor heating, but these must be insulated to keep surface temperature below 81°F (27°C).

Electrical underfloor heating

Please consult manufacturers to ensure their system is compatible with our flooring. Mesh/wire systems must be bedded into a basecoat of reinforced fibre smoothing compound. Then a second coat of primer and reinforced fibre smoothing compound should be applied. The room temperature must be between 64-81°F (18-27°C) prior and during installation.

Other floors

Consult your supplier.

Installation

Korlok should be laid with an expansion gap of 0.2" (5 mm) around the perimeter of the room and all fixed objects, including pipes. This must be increased to 0.33" (8 mm) for areas larger than 1000 sqft (100 m²). Consult your supplier for larger areas.**

Skirting boards should be removed and door frames undercut to allow for possible expansion. Alternatively a suitable edge trim should be used to cover the expansion gap.

Plank products should be laid with staggered joints, at a distance of at least 10" (250 mm).

Tools

For a successful installation, the following tools will be necessary – pencil, utility knife, ruler/straight edge, carpenter's square, saw, hand roller, pull bar, hammer and rubber mallet are recommended.

Exclusions

Special care must be taken when installing **Korlok** in rooms that are exposed to large temperature fluctuations e.g. unheated rooms, conservatories or direct sun / through south facing patio doors. In these cases, a 0.4" (10 mm) expansion gap should be used. Adhesives are not recommended in the installation of this product.

* Water will not penetrate through the product from one side to the other. This does not include joints between individual tiles/plank.

**Where the flooring run exceeds 50 ft (15 m) in width or length, an 0.33" (8 mm) expansion joint should be used and repeated thereafter.

1. First check the width of the room and calculate how many full rows will fit; the remaining space should be halved to indicate the width of the first and last row of planks. If the space is calculated to be less than 6" (150 mm), the number of full rows should be reduced by one and the width of the cut planks in the first and last rows is increased accordingly. Install the plank with the tongue side/cut edge facing the wall, fit 0.2" (5 mm) spacers between the plank and wall (Fig. 1).
2. Lay the first row, ensuring the short edges are clicked together (Fig. 2).
3. Using a knife and straight edge, cut the last piece of the row to size making sure that there is a 0.2" (5 mm) gap between the end of the row and the wall.
4. Start the second row by clicking the tongue into the groove holding the plank at an angle (approximately 30°), then tap the plank firmly into the groove of the first row. Fit the next plank by easing the tongue and groove together on the longside. The end joint can then be tapped into position with the next plank. (Fig. 3).
5. Continue to fit planks across the room until the row is complete. Where necessary, use a rubber mallet and an off-cut of the product or a hand roller to securely fix the planks together (Fig. 4 & 5). A pull bar can be used to pull the product together around the edges of the room (Fig. 6).
6. Repeat section 4 and 5 until the installation is complete.
7. Under door frames: If plank/tile cannot be lifted use an adapted tapping block (or cut off material) and mallet to carefully tap the plank/tile together flat on the floor (Fig. 7).
8. When fitting convex corners, around corners or complex profiles, mark the shape on the plank and cut using a saw.
9. Once the floor is fitted, remove the spacers; sweep the floor with a soft brush. Fix the skirting boards or suitable edge trim (available from your local dealer/distributor) to cover the expansion gaps. These should be fixed to the wall and not the floor (Fig. 8 & 9).

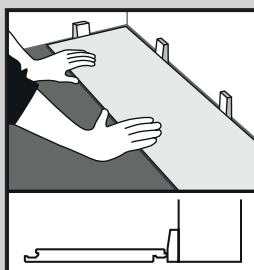

Fig. 1

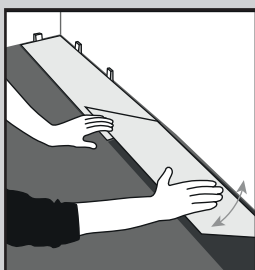

Fig. 2

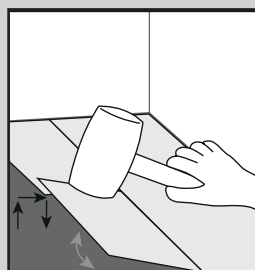

Fig. 3

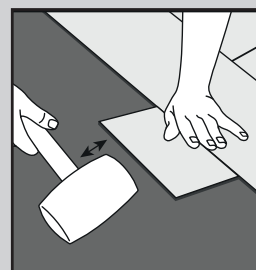

Fig. 4

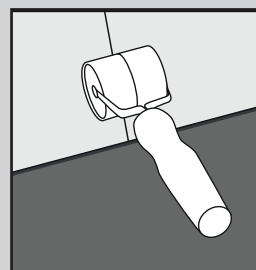

Fig. 5

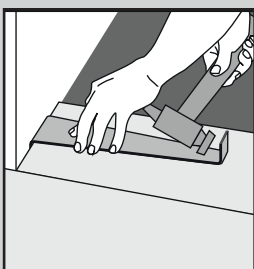

Fig. 6



Fig. 7

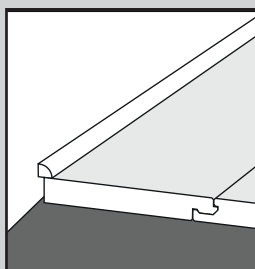

Fig. 8

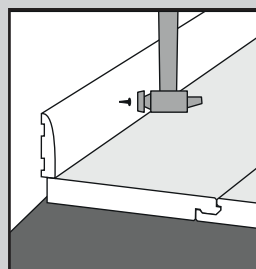

Fig. 9

Taking care of your floor

- Regularly sweep the floor to remove loose dirt or grit as these can cause fine scratches.
- For a thorough clean, a range of cleaning products is available (Clean, Remove and Refresh). Avoid the use of regular household cleaners and bleach-based detergents. These could make the floor slippery or cause discoloration.
- Always mop up spills as soon as possible, to reduce the risk of slipping and possible staining.
- Use entrance mats to protect against grit and moisture. Ensure they are of non-staining variety (not rubber-backed) to prevent any discoloration of the floor.
- Avoid sliding or dragging furniture or other objects across the floor - use floor protector pads to prevent scratching.
- Use castor cups to protect against indentation from heavy furniture.
- Maintain room temperature between 55-81°F (13-27°C) for optimum performance.
- Do not subject **Korlok** to standing water as this will present a slip hazard.